

Title Number : AGL219596

This title is dealt with by Land Registry, Wales Office.

The following extract contains information taken from the register of the above title number. A full copy of the register accompanies this document and you should read that in order to be sure that these brief details are complete.

Neither this extract nor the full copy is an 'Official Copy' of the register. An official copy of the register is admissible in evidence in a court to the same extent as the original. A person is entitled to be indemnified by the registrar if he or she suffers loss by reason of a mistake in an official copy.

This extract shows information current on 9 JAN 2015 at 09:27:58 and so does not take account of any application made after that time even if pending in the Land Registry when this extract was issued.

REGISTER EXTRACT

Title Number	: AGL219596
Address of Property	: The Prince Of Wales Public House, 1 Finsbury Road, London (N22 8PA)
Price Stated	: £20,000
Registered Owner(s)	: KATARZYNA WASSEF of 1 Finsbury Road, London N22 8PA.
Lender(s)	: None

Title number AGL219596

This is a copy of the register of the title number set out immediately below, showing the entries in the register on 9 JAN 2015 at 09:27:58. This copy does not take account of any application made after that time even if still pending in the Land Registry when this copy was issued.

This copy is not an 'Official Copy' of the register. An official copy of the register is admissible in evidence in a court to the same extent as the original. A person is entitled to be indemnified by the registrar if he or she suffers loss by reason of a mistake in an official copy. If you want to obtain an official copy, the Land Registry web site explains how to do this.

A: Property Register

This register describes the land and estate comprised in the title. Except as mentioned below, the title includes any legal easements granted by the registered lease but is subject to any rights that it reserves, so far as those easements and rights exist and benefit or affect the registered land.

HARINGEY

- 1 (12.10.2010) The Leasehold land shown edged with red on the plan of the above title filed at the Registry and being The Prince Of Wales Public House, 1 Finsbury Road, London (N22 8PA).
- 2 (12.10.2010) Short particulars of the lease(s) (or under-lease(s)) under which the land is held:
Date : 22 January 2008
Term : 25 years from 26 February 2003
Parties : (1) Punch Taverns (PTL) Limited
(2) Martin Gerard Hession
- 3 (12.10.2010) The Lease prohibits or restricts alienation.
- 4 (12.10.2010) The title includes any legal easements referred to in clause LR11.1 of the registered lease but is subject to any rights that are granted or reserved by the lease and affect the registered land.
- 5 (12.10.2010) The landlord's title is registered.

B: Proprietorship Register

This register specifies the class of title and identifies the owner. It contains any entries that affect the right of disposal.

Title absolute

- 1 (04.03.2013) PROPRIETOR: KATARZYNA WASSEF of 1 Finsbury Road, London N22 8PA.
- 2 (12.10.2010) The price stated to have been paid on 22 January 2008 was £20,000.
- 3 (15.05.2014) RESTRICTION: No disposition of the registered estate by the proprietor of the registered estate or by the proprietor of any registered charge not being a registered charge before the entry of this restriction is to be registered without a written consent signed by Nader Fanous Lewis or his conveyancer Myers Fletcher & Gordon solicitors of 15 Cambridge Road, 210 Shepherds Bush Road, London W6 7NJ.

End of register

Land Registry

Current title plan

Title number **AGL219596**
Ordnance Survey map reference **TQ3090NE**
Scale **1:1250**
Administrative area **Haringey**

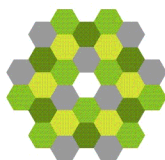

©Crown Copyright. Produced by Land Registry. Reproduction in whole or in part is prohibited without the prior written permission of Ordnance Survey. Licence Number 100026316.

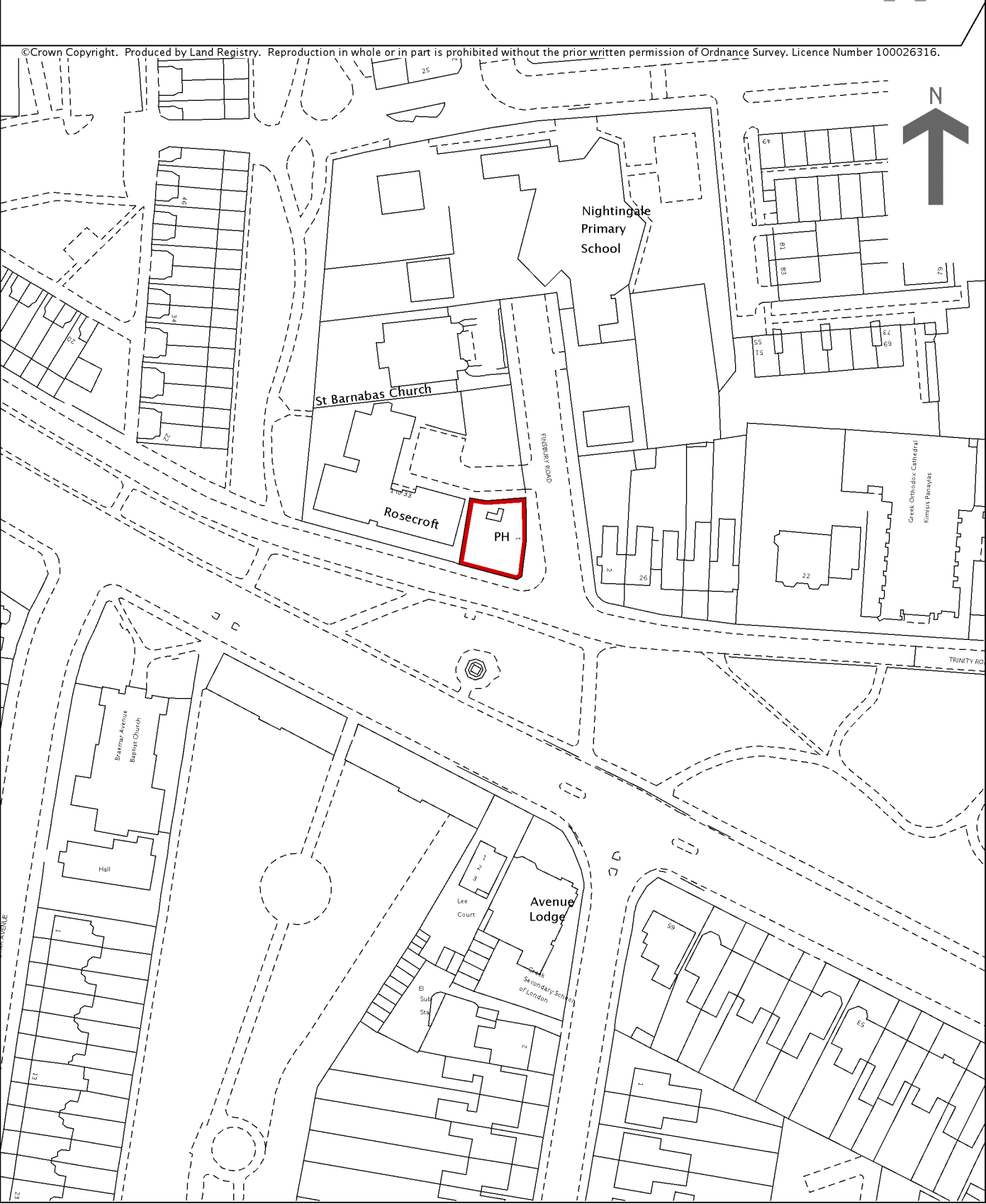

This is a copy of the title plan on 9 JAN 2015 at 09:27:59. This copy does not take account of any application made after that time even if still pending in the Land Registry when this copy was issued.

This copy is not an 'Official Copy' of the title plan. An official copy of the title plan is admissible in evidence in a court to the same extent as the original. A person is entitled to be indemnified by the registrar if he or she suffers loss by reason of a mistake in an official copy. If you want to obtain an official copy, the Land Registry web site explains how to do this.

The Land Registry endeavours to maintain high quality and scale accuracy of title plan images. The quality and accuracy of any print will depend on your printer, your computer and its print settings. This title plan shows the general position, not the exact line, of the boundaries. It may be subject to distortions in scale. Measurements scaled from this plan may not match measurements between the same points on the ground.

This title is dealt with by Land Registry, Wales Office.